

The All Purpose Modular Wall System

The heart of any modular building is its framing system and The OmniFlex 300 leads the industry. Whether you need a simple supervisor's office or a two-story office with mezzanine, OmniFlex 300 modular wall systems offer a high quality, low cost solution. This versatile steel stud framing system utilizes 3" thick walls that support loadbearing roofs and two-story construction without the need for costly support columns. It is our most popular and best value 3" framing system ever.



Modular Flexibility

With OmniFlex walls, whenever you change your plant layout, your modular building can change with it. Non progressive construction makes it easy to expand, modify, or relocate these units. So, you save time and money in the future, as well as on your initial modular building investment.

Structural Integrity

With stud sections that physically connect back-to-back, OmniFlex provides the strongest loadbearing system on the market. The unique double layer steel studs provide more strength at a lower cost than single layer studs and the rolled ends reduce tear risks during assembly.



OmniFlex 300 Stud Construction

Solid construction of two-piece steel studs joined together make OmniFlex stronger than any comparable 3" system. To assure long life we use only the best materials, including galvanized, bonderized steel, with baked enamel finish on all exposed metal parts.

Professional Appearance

Color coordinated panels, studs, doors, and trim, bring a professional "front office" finish to OmniFlex in-plant buildings. Standard colors are champagne, gray and white with matching trim and wall panels for a smooth monochromatic finish. Optional colors can be ordered.



Implant Offices

Modular offices with sound deadening wall panels keep production personnel out on the plant floor and close to the action while providing a clean, quiet environment in which to work.

Modular Electric

With PortaFab's optional 'plug and snap' modular electrical package, your implant office will be outfitted with everything it needs for a simple installation. All outlet boxes, switches, wiring, and conduit fit neatly into the studs of the framing system.

Loadbearing Roof Wall System

OmniFlex system can be designed to support any type of roof loading beyond the weight of the lights and ceiling itself. Design criteria include man loads, 2-story, roof-mounted HVAC and duct work, and storage loads. Please consult factory for specific needs.

Wiring Studs

Removable "snap-in" cover plates allow for wiring capabilities on both sides of the stud and easy inspection of raceways without affecting the structural integrity of the stud.

Excellent Value

OmniFlex modular buildings offer quality, appearance, and cost savings that make conventional construction obsolete. They are completely re-usable so your modular building can grow with your business. You save time and money in the future, as well as on your initial investment.



OmniFlex Plus Features

Heights: Standard wall heights up to 18 feet.

Thickness: 3" thick wall panels

Loadbearing: Yes

Stud Construction: Steel stud construction with unique design that enables fast, easy assembly and provides quick access to wiring on both sides of the wall.

Colors: Standard colors are champagne, gray and white. Optional colors can be ordered. All exposed trim and framing is finished in baked enamel. With steel panel option, trim and framing can match wall panel color choice for a smooth monochromatic finish.

Re-Usable: Expandable and relocatable units are 100% re-usable and qualify for accelerated depreciation in most cases.

Easy to Install: Uncomplicated construction for quick and easy installation.

Adaptable: Modular construction allows for nearly any configuration – including 2-story, mezzanine, 2, 3, or 4 wall units.

Customizable: Windows and doors can be moved without disturbing adjacent panels or ceiling.

Doors: Heavy-duty, 20 gauge steel door with baked enamel finish and 18 gauge frame with mortised hinges, sweep, and key-in-knob lockset.

Windows: 1/4" thick clear tempered safety glass.

Base: Removable, screw-on, vinyl base.

Wall Panels

Standard

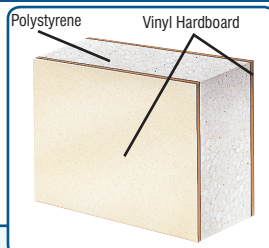

Typically chosen for low cost, standard hardboard panels provide excellent thermal insulation and can be made with a wide variety of surface finishes. Available with vinyl or steel surfaces.

Fire & Sound

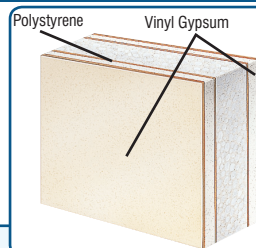

Our most popular panels, these Class A non-combustible panels provide great sound reduction and excellent thermal properties while meeting most of today's building codes.

Steel Fire & Sound

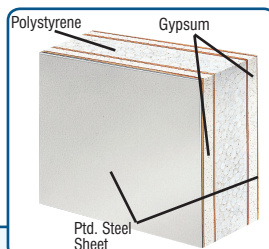

Similar to standard Fire & Sound Panels with a steel surface. Ideal for areas subject to a significant amount of traffic or exposure to hand trucks, or other material handling equipment.

Specialty

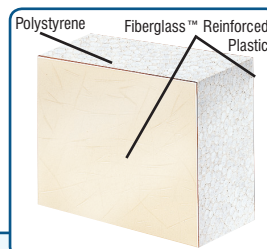

Alternate surfaces and cores are available to meet requirements of any application. Surfaces offered include melamine, vinyl, various steels, and high-pressure laminates with a variety of cores.

PortaFab Corporation

18080 Chesterfield Airport Road

Chesterfield, MO 63005

Tel: 1-800-325-3781 1-636-537-5555

Fax: 1-636-537-2955

e-mail: info@portafab.com

www.portafab.com

PORTAFAB
Modular Building Systems