

- GENERAL NOTES:
- 1) ALUMINUM FRAMING EXTRUSIONS HAVE A MIL. FINISH.
 - 2) FIXED WINDOWS TO INCLUDE CLEAR TEMPERED GLAZING.
 - 3) UNIT INCLUDES FACTORY INSTALLED INTERNAL ROOF WITH PERIMETER GUTTER. (NO FLOORING PROVIDED).
 - 4) UNIT PROVIDED FACTORY ASSEMBLED.

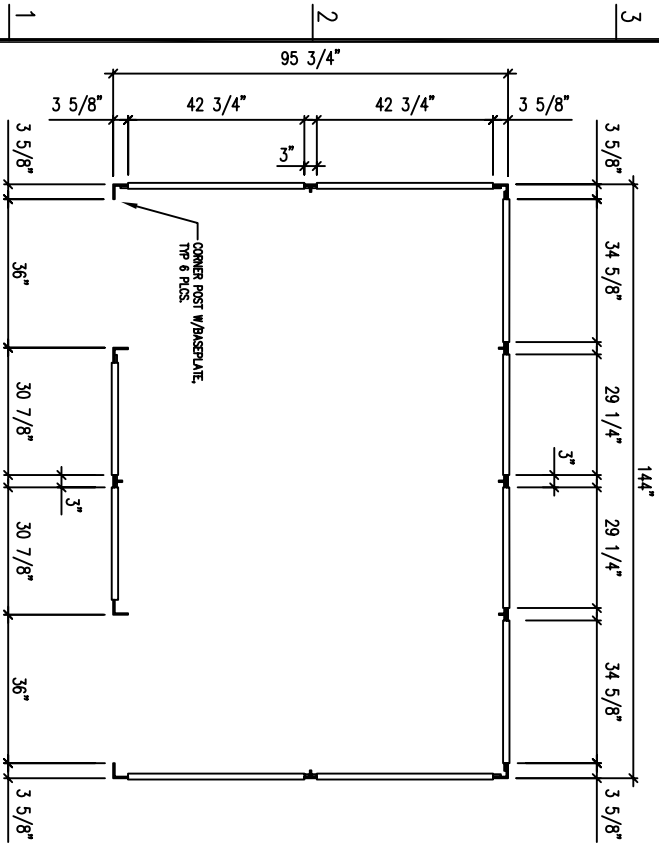

STYLE 'C' FLOOR PLAN

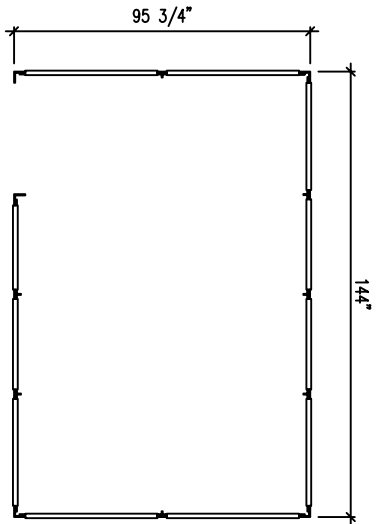

STYLE 'A' FLOOR PLAN

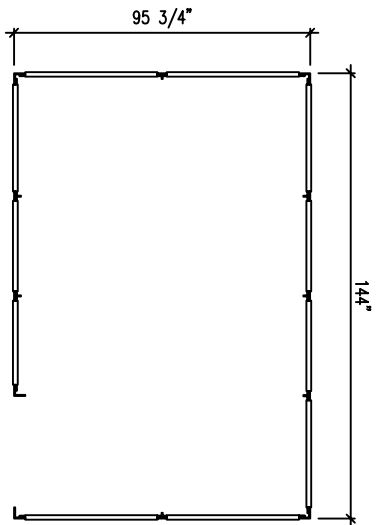

STYLE 'B' FLOOR PLAN

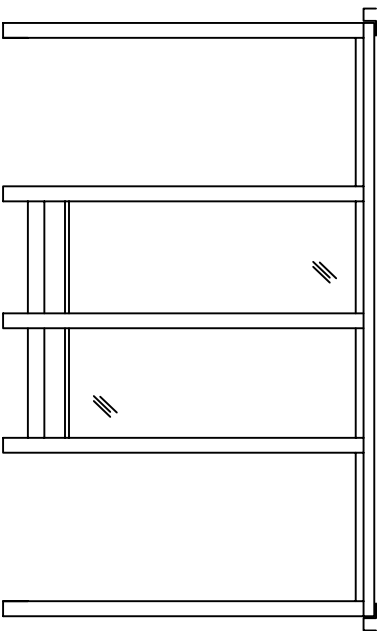

WALL ELEVATION

| | | | | | | | | | |
|-----------|-------------|------------|--------------------------------|--------------|---|--|------|-------------|------|
| ORDER NO. | DRAWN BY: | DATE: | PRE-ASSEMBLED | P.O. | PORTAFAB CORPORATION 18000 CHESTERFIELD AIRPORT ROAD, CHESTERFIELD, MO 63005 email: engineering@portafab.com (800) 325-3781 | These documents were developed by PORTAFAB Corporation. The drawings are the property of PORTAFAB Corporation. They are not to be copied or otherwise used without the express written permission of PORTAFAB Corporation. | REV. | DESCRIPTION | DATE |
| | CD | | PANEL HEIGHT: N/A | | | | | | |
| SHEET NO. | CHECKED BY: | SHIP DATE: | PANEL FINISH: PEARL (#750) FRP | 8x12 SHELTER | | | | | |
| | N/A | RENSED: | PANEL CONSTRUCTION: | | | | | | |
| 1 OF 1 | | | | | | | | | |

SUPPLIER MAKES NO REPRESENTATION THAT THE BUILDING OR COMPONENT DEPICTED HEREIN COMPLEES WITH APPLICABLE CODES OR ORDINANCES. PURCHASER SHOULD VERIFY COMPLIANCE WITH SUCH CODES AND ORDINANCES.